

NEEDLE AND THREAD GUIDE

Use only the correct needle system as recommended by Handi Quilter. For the Moxie ST, this is needle system 134. This needle system is designed to withstand high stitching speeds. Choose among sizes 12 through 20 according to the type of thread you are using.



NEEDLE SIZE	THREAD SIZE
12 and 14	monofilament, 100 wt. silk, 60 wt. poly, mylar
16	monofilament, hologram, 100 wt. silk, 60 wt. poly, 50 wt. poly, 50 wt. cotton, some 40 wt. threads
18	40 wt. cottons and poly, 30 wt. cottons and poly
20	Any thread 30 wt. and heavier such as 12 wt., 19 wt., 30 wt.

TO THREAD THE HQ MOXIE ST

- Place thread cone onto spool post ①, insert the thread through the thread-mast eyelet ② from right to left, continuing to the 3-hole thread guide ③.
- Thread all three holes from back to front ④, wrapping as you go, and being careful not to cross threads. **NOTE:** This is recommended for most threads. Very delicate threads, e.g. metallic threads or monofilament, may require less tension. If you have problems with thread breaking, try threading only one or two holes ④.
- The thread continues down through thread guide ⑤ and then to the tension assembly ⑥. **IMPORTANT:** The thread must be flossed up between two tension discs. If not flossed all the way up, the thread will lay on top of the tension discs (no tension) and thread looping on the bottom of the quilt can occur.
- After the thread is in the tension disks, be sure that the thread catches on the take-up spring and then pull it down under the stirrup thread guide ⑦.
- Bring the thread up and through the take-up lever from back to front ⑧, and then through the lower thread guide ⑨. Almost there! Thread through the needle bar thread guide hole, this time from front to back ⑩.
- Make sure the thread follows the groove down the front of the needle ⑪ and insert thread through the eye of the needle from front to back. While pulling thread through the eye of the needle be careful that the thread does not twist around the needle.

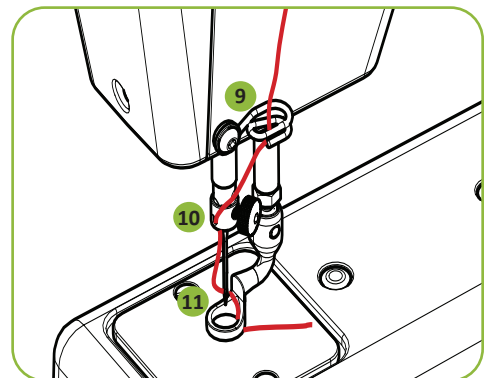
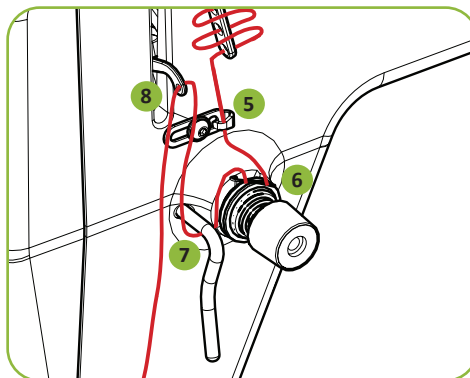
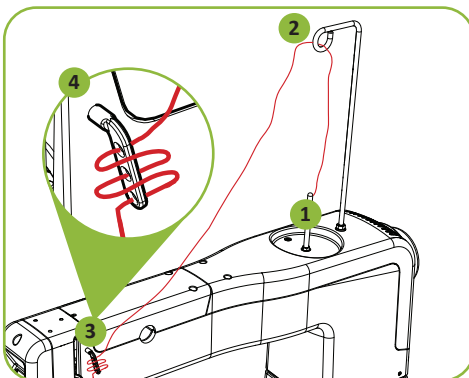

HQ MOXIE ST SCREEN ICONS AND NAVIGATION

Home Screens: Where you'll be when sewing! (See *Stitching Modes* section for more information.)

Manual

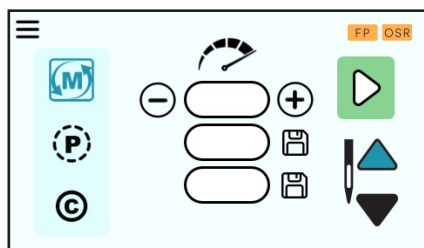

The needle cycles continuously at the same speed, regardless of the movement of the quilt.

Precision

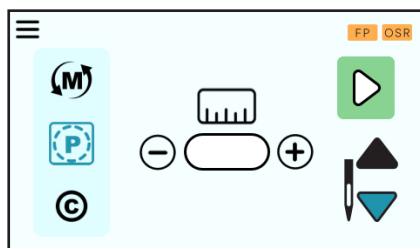

The needle cycles according to the movements of the quilt to maintain the stitch length.

Cruise

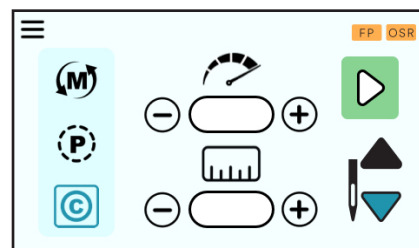

The needle cycles continuously, but it changes speeds to maintain the stitch length when the quilt is moved.

Note: FP (Foot Pedal) and OSR (Optical Stitch Regulation) show orange only when the FP cable and OSR cable are connected.

MACHINE TOOLS ICONS

Access from the Home screen by clicking this icon.



Needle-stop position: Select the arrow for the desired end needle position for when you stop stitching. The blue arrow is the selected stop position. Push the blue arrow once and it does a half stitch. Push and hold the blue arrow and it does a walking stitch until released.



Lights: Select this icon to adjust the brightness of lights. Press to return to the menu.



Overspeed Alarm: Select to toggle the alarm on or off. The alarm lets you know if you are quilting too fast for stitch regulation. Press to return to the menu.



Stitch Count: Select this to view your project stitch count and your machine's lifetime stitch count. Press the Project count button to reset the count to zero when starting a new quilt. Press to return to the menu.



Diagnostics: Use when directed by Handi Quilter technical support or authorized representative to run diagnostic tests. Press to return to the menu.



Updates: Machine and display software should be downloaded from the website to a USB drive when a new version is released. Press to return to the menu.



System Information: Show machine and display hardware and firmware versions. Press to return to the menu.



Return Home: Returns you to your most recent home screen. Press to return to the menu.

STITCHING MODES

Select from the Menu screen.

Manual Stitching Mode: Select the Manual icon () and then specify the stitches per minute (speed).

When using manual stitching mode, the length of the stitch is determined by how quickly or slowly you move the quilt, in combination with the number of stitches per minute (up to 2100) that you choose.

For a consistent stitch length, move the quilt at a consistent speed. Experiment with different combinations of quilting speed and stitches per minute to find what optimally works for you.

Precision Stitch Regulation: Select the Precision icon () and then specify the stitches per inch.

Stitch regulation maintains a consistent stitch length (stitches per inch), regardless of how quickly or slowly you move the quilt. When quilting in Precision mode, the needle only moves when you move the quilt. After you press the play key on the display or press the foot pedal, move the quilt to begin quilting according to the stitches-per-inch setting. When you pause moving the quilt, the needle will pause until you move it again. Press the pause key on the display or release the foot pedal to fully stop quilting. Ideal for ruler work.

Cruise Stitch Regulation: Select the Cruise icon () and then specify the cruise speed (stitches-per-minute) setting.

When quilting in Cruise mode, the needle will start to move immediately when you press the play key on the display or the foot pedal, according to the cruise speed (stitches-per-minute) setting. Once you begin to move the quilt, the needle will move according to the stitches-per-inch setting.

The needle continues to move at the Cruise speed (stitches per minute) anytime you stop moving the quilt, until you press the pause button on the display or release the foot pedal.

For more information about tools and settings, see the *Machine Tools and Information Screen* sections of the Moxie ST manual.