

# 20-inch Stationary Longarm Table Insert Assembly Instructions

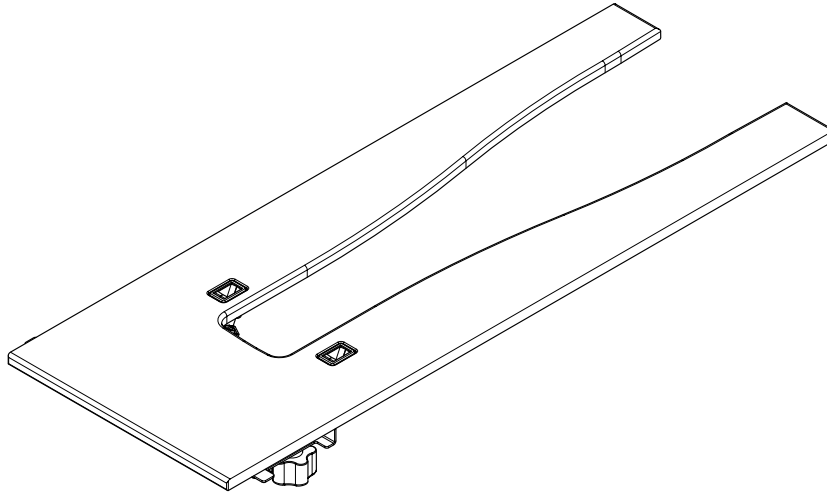

## Table of Contents

What's Included.....	2
Replacement Parts and Hardware.....	3
Adjust Machine Stand Plate .....	5
Install the Ruler Base Posts .....	6
Adjust the Insert.....	7
Install the Insert Assembly .....	8
Make Fine Adjustments of Machine Stand Plate (if needed) .....	9
Connections.....	10
Care and Cleaning .....	10

## Introduction

This sit-down table utilizes an insert that is cut especially to fit different machines. The insert and insert instructions are packaged separately from the table. The table has an adjustable stand plate for fine-tuning the machine height to match the table top and the insert. The final stand plate adjustment will be made by checking the machine height and positioning the plate to the insert.

## What's Included

QT09041, 20-inch Insert Assembly

<b>Preassembled Parts</b>	<b>Quantity</b>
20-inch insert assembly with connection cables and sensors for the stationary longarm table	1

<b>Additional Parts Included</b>	<b>Part Number</b>	<b>Quantity</b>
Screw – M5x15 SKC ZN	QM10176	8
Washer – M5	QM10250	8
Nut – M5 Nyloc	QM10751	8
Ruler Base Posts	QM11729	8
Hex Key L 4mm	QM10288	1
Combo Wrench 8mm	QM40235	1

# Replacement Parts and Hardware

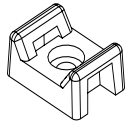

Mount Cable Tie M4  
(2) QM40222

NOT SHOWN

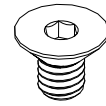

Screw-M4x6 SKF ZN  
(2) QM10033

Cable Wire Tie  
(2)

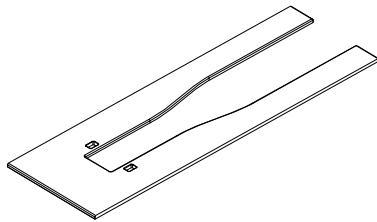

Insert Insight2 20"  
(1) QT09040-120

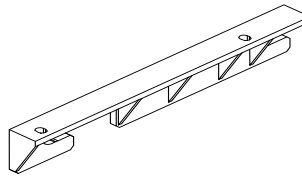

Latch Ruler Base Left  
(2) HG00458-03

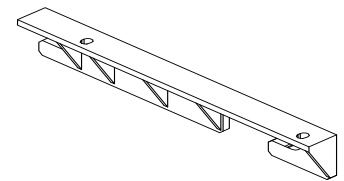

Latch Ruler Base Right  
(2) HG00458-02



Screw-M4x8 PHP ZN  
(9) QM10867

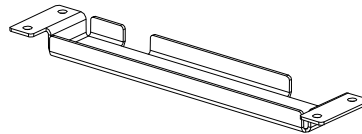

Cover Control Board InSight2  
(1) QT09040-105



Screw-M4x6 PHP ZN  
(4) QM00500-14

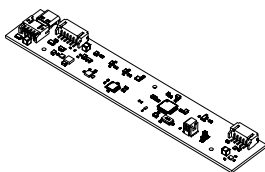

Board-Base OSR - 20"  
(1) QM20067-4

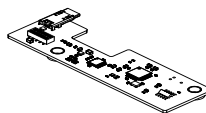

Board-Base OSR - 20"  
(1) QM20063

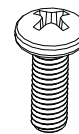

Screw-M4x12 PHP ZN  
(2) QM10179

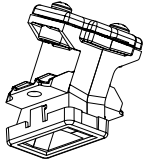

Sensor Assy-OSR  
(2) QM10072

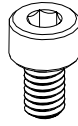

Screw-M4x6 SKC ZN  
(4) QM20802-4-129

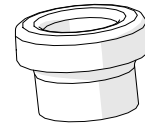

Ruler Base Post  
(8) QM11729

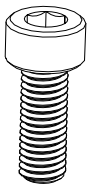

Screw-M5x14 SKC ZN  
(8) QM10176

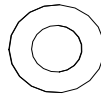

Washer M5  
(8) QM10250

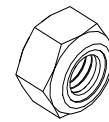

Nut M5 Nyloc  
(8) QM10751



Hex Key L 4mm  
(1) QM10288

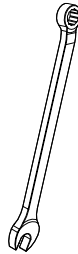

Combo Wrench 8mm  
(1) QM40235



Cable-Analog Foot Pedal  
(1) QM10075



Cable-USB Type A plug to Micro  
(1) QM10088

## Adjust Machine Stand Plate

 **NOTE:** This table assembly instructions must be completed before continuing with the following instructions.

### Tools Needed:

5mm L hex tool (provided with table)

Wedge tool (provided with table)

1. Place the machine in the table on the Machine Stand Plate.
2. Align the machine with the opening.
3. Using a ruler or level to span the opening in the table, compare the height of the machine bed to the table top. At this point, the plate may be either too high or too low.
4. To adjust the height, carefully loosen the two front screws holding the Machine Stand Plate with the 5mm L hex tool (provided with the table), and adjust the plate up or down as needed using the provided wedge tool until the desired height is achieved. Lightly tighten these two front screws.
5. The rear of the machine is much heavier than the front of the machine. Carefully loosen the two rear screws holding the Machine Stand Plate, and adjust the plate up or down as needed using the wedge tool until the desired height is achieved. Lightly tighten these two screws.
6. After confirming the Machine Stand Plate is level and at the desired height, firmly tighten all four Machine Stand Plate screws.

 **NOTE:** This table utilizes an insert that is custom sized to fit specific machines. The insert with built-in stitch regulation sensors and cables for attaching to your stationary longarm machine and its assembly instructions are packaged separately.

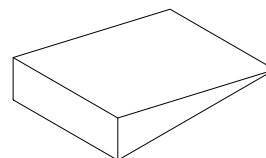
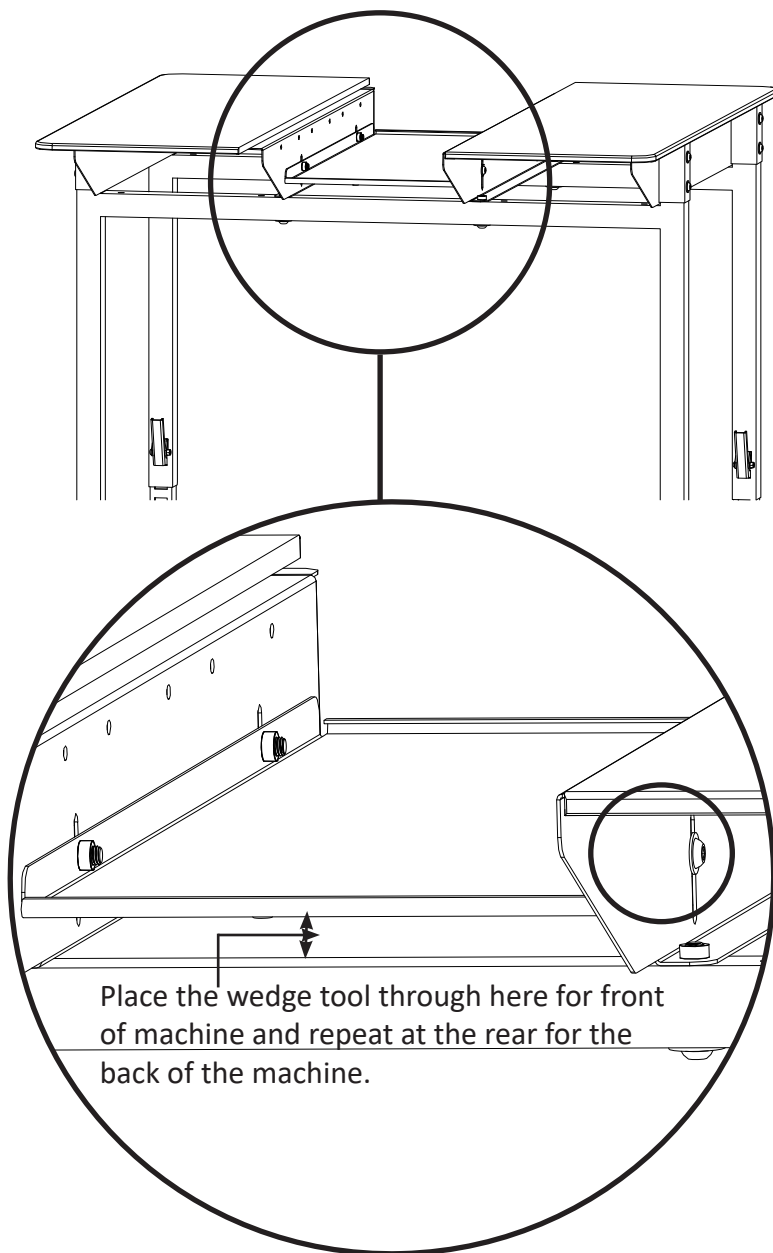

The wedge tool is included with the table, not the insert.

# Install the Ruler Base Posts

ITEM	PART 3	DESCRIPTION	QTY
1	QM11729	RULER BASE POST	8
2	QM10176	SCREW - M5X14 SKC ZN	8
3	QM10250	WASHER - M5	8
4	QM10751	NUT - M5 NYLOC	8

### Tools Needed:

Hex Key 4mm (Provided)

Combo Wrench 8mm (Provided)

 **NOTE:** The table is designed to accommodate machines from 15 inches to 20 inches, so it has 3 sets of two holes on both the left and right sides. The 20-inch machine uses the front set and the rear set for the ruler base posts and insert.

1. Remove the machine from the machine stand plate and set it aside.
2. Install two ruler base posts with M5x14 SKC screws, M5 washers, and M5 nyloc nuts using the front set of holes on the left side.
3. For now, only snug the screws with the 4mm hex tool and 8 mm combo wrench so the posts can be moved slightly for the final adjustment later on.
4. Repeat **Steps 2 and 3** on the front right side.
5. Install two ruler base posts at the rear set of holes on the left side.
6. For now only snug the screws so the posts can be moved slightly for the final adjustment later on.
7. Repeat **Steps 5 and 6** at the right rear of insert.

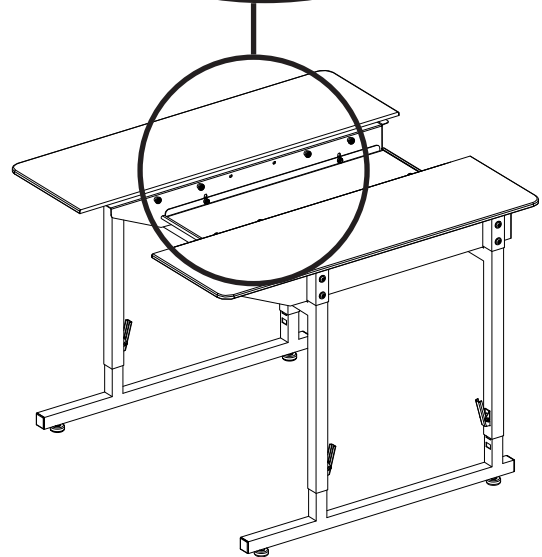
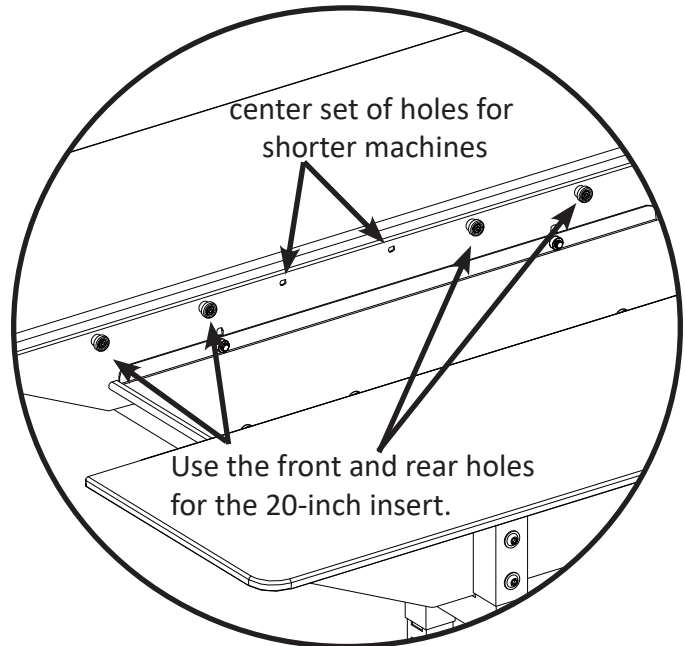
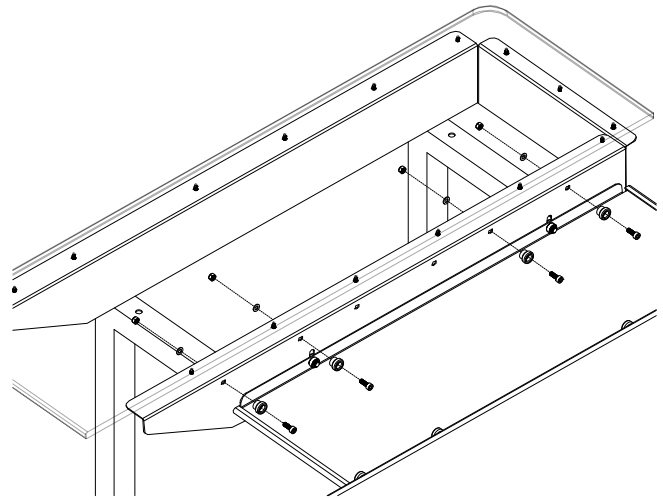

# Adjust the Insert

## Tools Needed:

Hex Key 4mm (Provided)

Combo Wrench 8mm (Provided)

1. With the posts installed and snug, slide the insert into place and snap it onto the 8 posts.
2. Align the insert with the front edge of the table top front to back and up and down on the left side.
3. Tighten firmly the two ruler base posts at the front on the left side, but **do not overtighten**.
4. Repeat Steps 2 and 3 but on the front right side.
5. Align the insert up and down and fully tighten the posts at the left rear of the insert.
6. Repeat Step 5 but at the right rear of insert.
7. Check that the front is still aligned and repeat the process if needed until the insert is aligned properly with the table top.

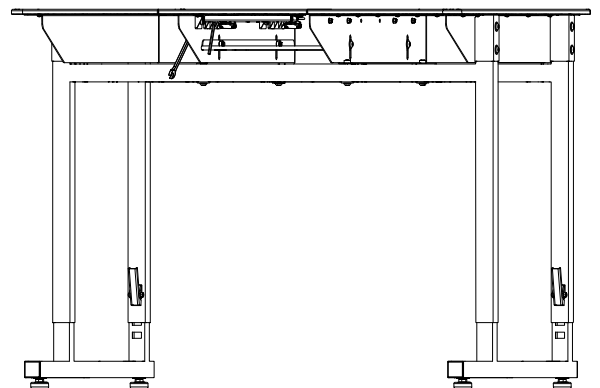
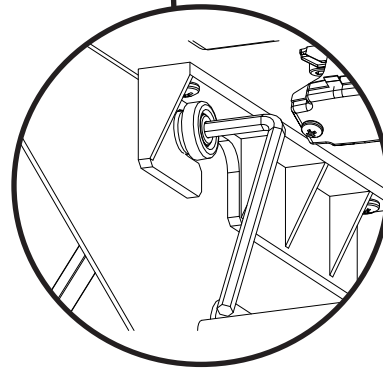
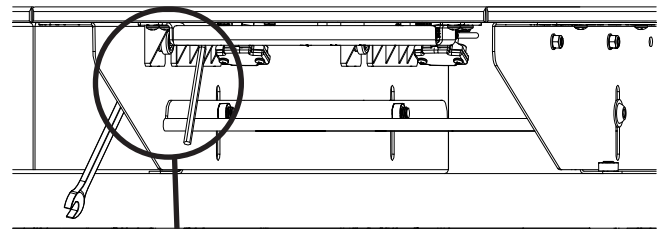
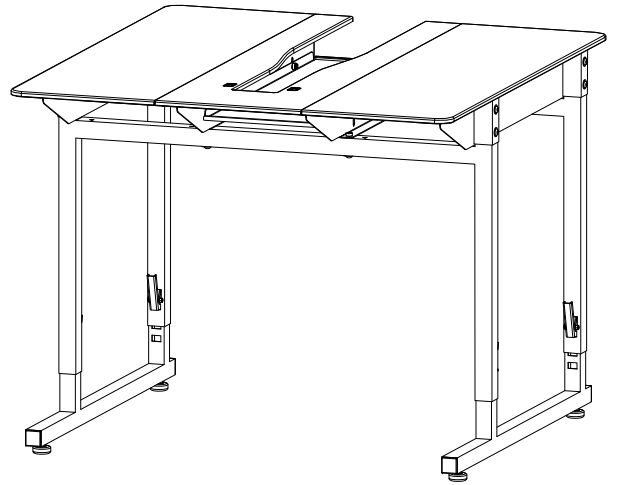

# Install the Insert Assembly

 NOTE: The sensors on the bottom of the insert will be very close to the machine. Care must be taken when positioning the machine front to back, side to side, and up and down, to ensure the sensors do not hit the machine when installing the insert into the table.

1. Remove the insert and place the insert face down on the right side of the table top with the smooth side down and the sensors up toward the ceiling.
2. Place the machine onto the machine stand plate, centering the machine left to right and positioning it back toward the rear of the stand plate. This will allow more room for you to slide the insert into place.
3. Run the front foot pedal extender cable with 1/8-inch mini jack back along the right side of the machine to the rear of the table. This cable will be under the insert along side the machine when you install the insert.
- 4 Run the front USB cable back along the right side of the machine to the rear of the table. This cable will be under the insert along side the machine when you install the insert.
5. Bring the insert toward you until you can turn it over counter-clockwise to the left.
6. Turn the insert over so the wires are now on the bottom to your right, bring the insert toward you to the front of the table and then slide it onto the eight ruler base posts you installed earlier until it snaps into place.
7. When positioned properly to the rear, all 8 post will snap onto the brackets. (See the previous page if any adjustments are needed.)
8. Slide the machine forward into the insert until there is as little gap between the machine and the insert as possible.

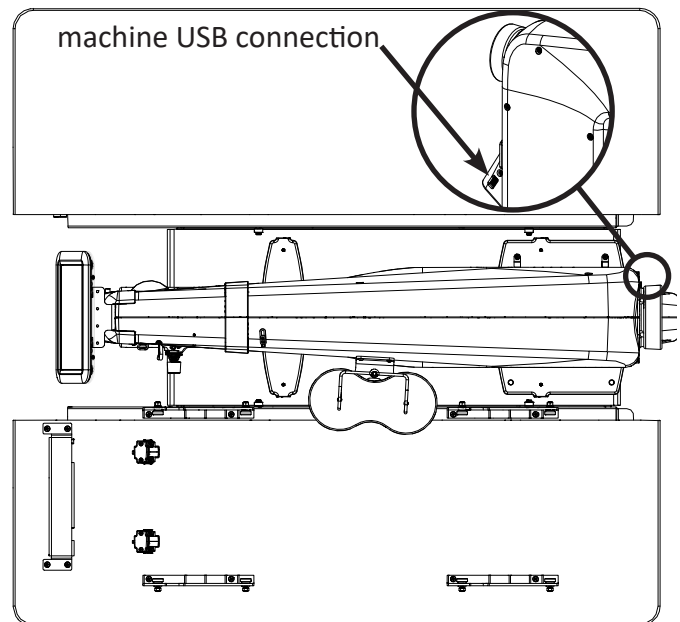
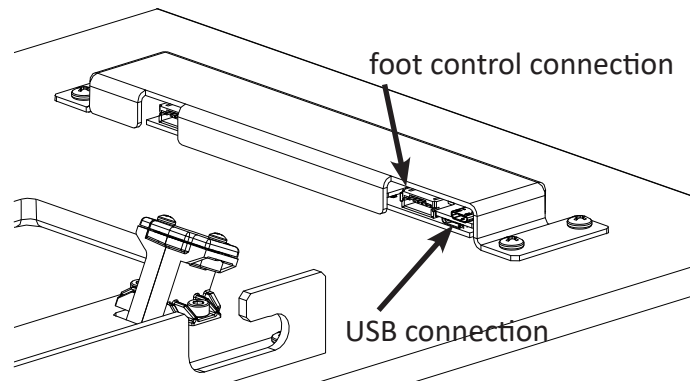
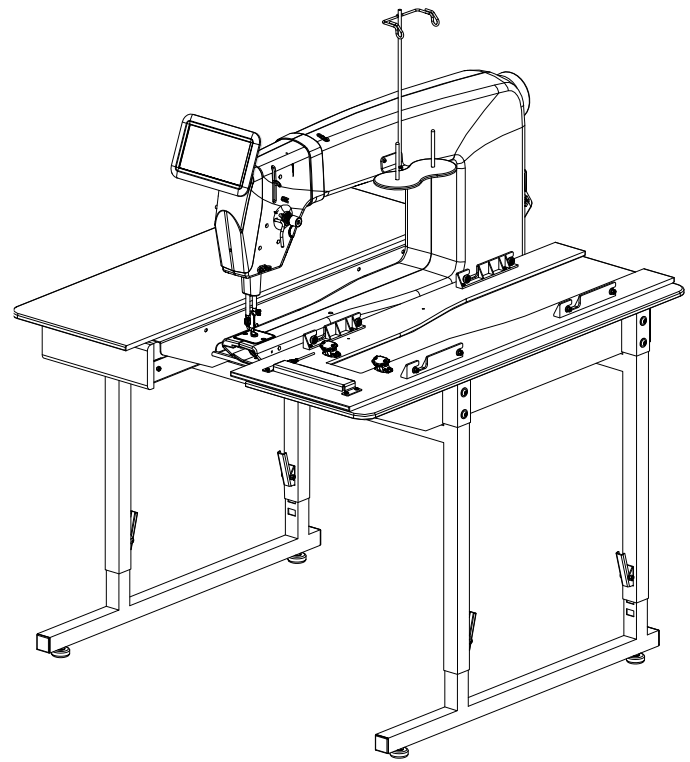



## Make Fine Adjustments of Machine Stand Plate (if needed)

### Tools Needed:

5mm L hex tool (provided with table)

Wedge tool (provided with table)

1. This adjustment is usually done with the machine and insert in place.
2. While holding up the front of the stand plate with the wedge tool, loosen the left and right front screws with the 5mm L hex tool provided with the table. Adjust the stand plate until the highest edge of the machine needle plate is just even or slightly below the insert.
3. Tighten the two front stand plate screws firmly.
4. Repeat **Steps 2 and 3** at the two rear stand plate screws.
5. If necessary, repeat the above steps until the stand plate is at the desired height.

 **NOTE:** Check the needle plate area with a straight edge or ruler to confirm the edge does not get caught on the needle plate. If it does, adjust the front of the stand plate accordingly.

 **NOTE:** If the stand plate is not adjusted so that all four machine rubber feet touch firmly, you may have undesirable machine vibrations at some speeds. Press on each corner of the machine to make sure the feet are touching and that the machine does not rock.

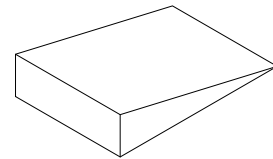
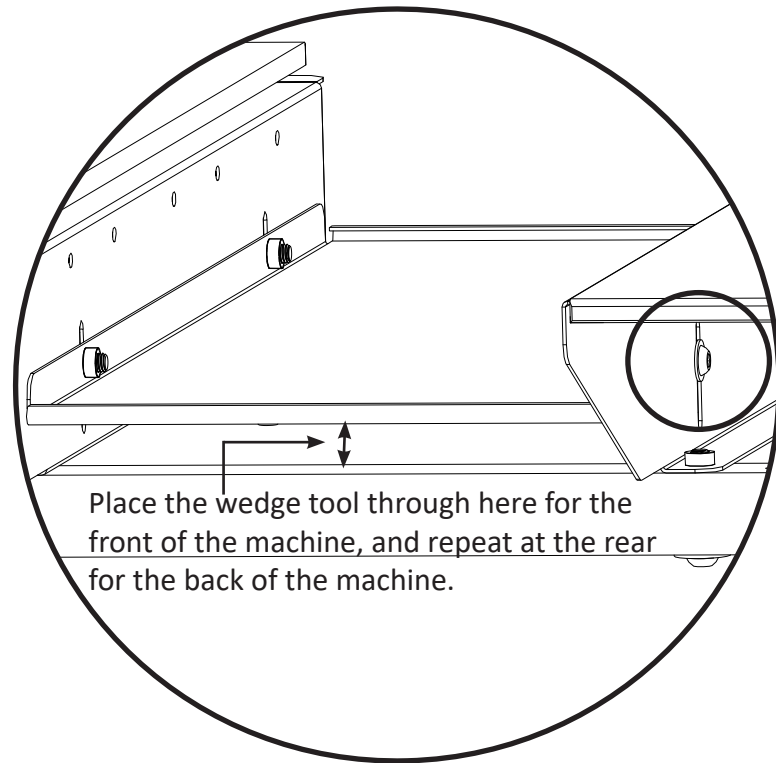

The wedge tool is included with the table, not the insert.

## Connections

1. Plug the USB cable into the USB connection at the left rear side of the machine.
2. Plug the foot control into the foot control extension cable.

 **NOTE:** The foot control cable has some extra cable length as a service loop for ease of assembly and use. The excess cable from the front should be tucked up inside the table onto the stand plate or at the rear of the table.

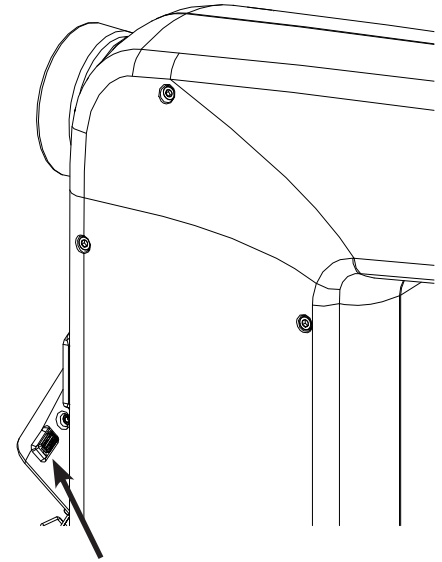

machine USB connection

## Care and Cleaning

 **IMPORTANT:** Care should be taken not to scratch the top surface of the sensors. They should not be cleaned with any cleaner, especially a liquid cleaner that might get into it or its circuitry. Treat them as an expensive pair of glasses and clean them only with an appropriate lens cleaning cloth for plastic lenses or glasses.

1. Keep the two lenses clean from dust and finger prints using a lens cleaning cloth for eye glasses.
2. Take care not to pinch or pull on cables when connecting, assembling, or moving the machine.

