

KNOW YOUR BOBBIN CASE

There are three types of bobbin cases that are used in various generations of HQ longarm machines. Do you know which type your machine uses? Get to know the subtle differences between bobbin cases, parts associated with each, and the importance of identification.

Pre-2017 Cerliani

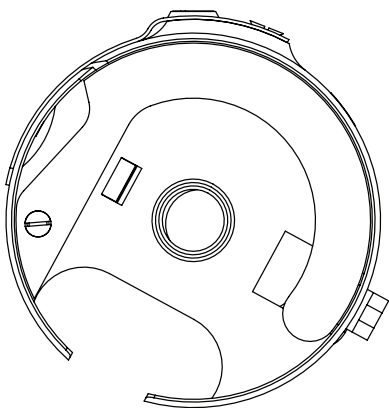
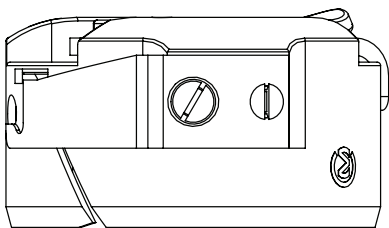
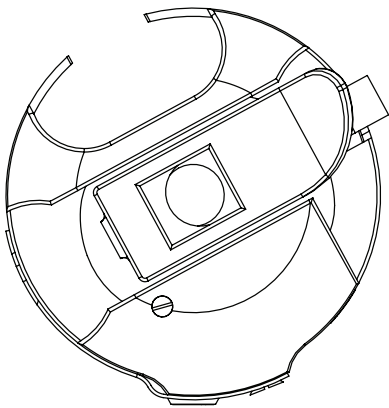

Post-2017 Cerliani

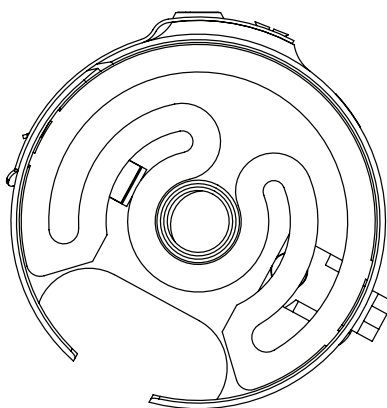
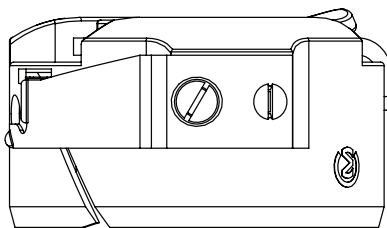
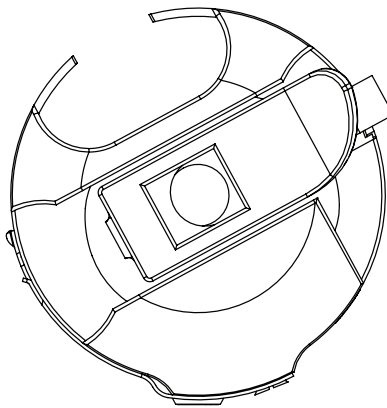

Koban

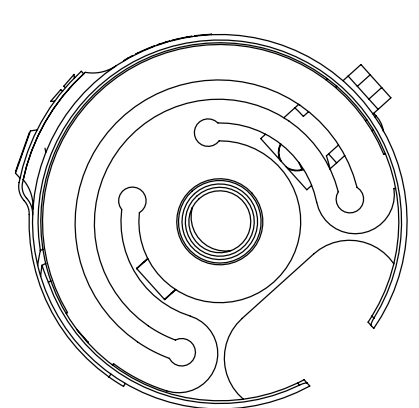
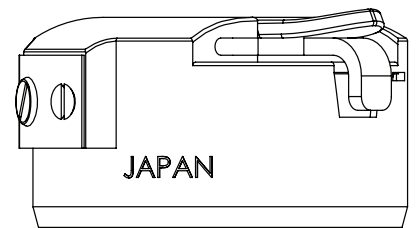
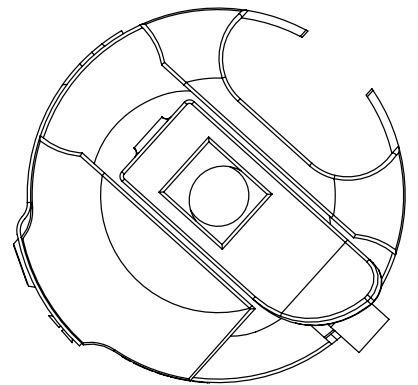

Handi Quilter
BY QUILTERS FOR QUILTERS

QM00586-01

Pre-2017 Cerliani

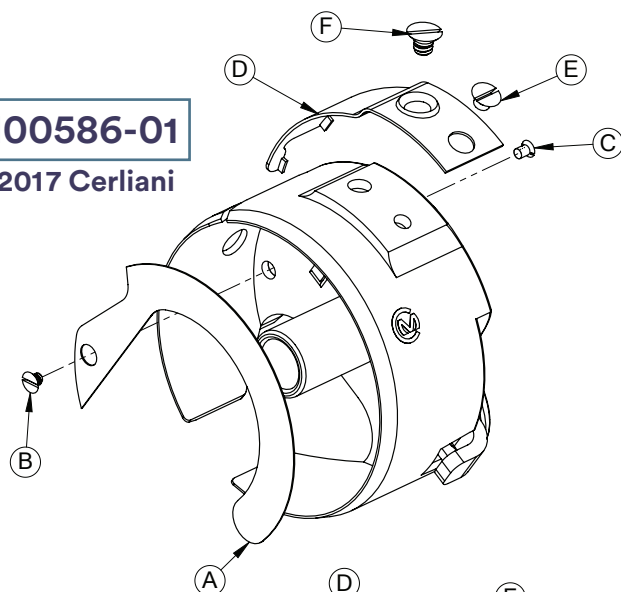

QM00586

Post-2017 Cerliani

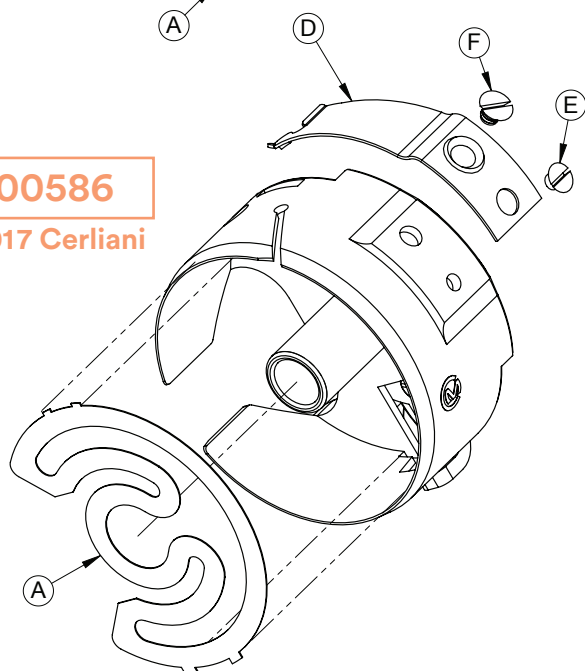

QM10587

Koban

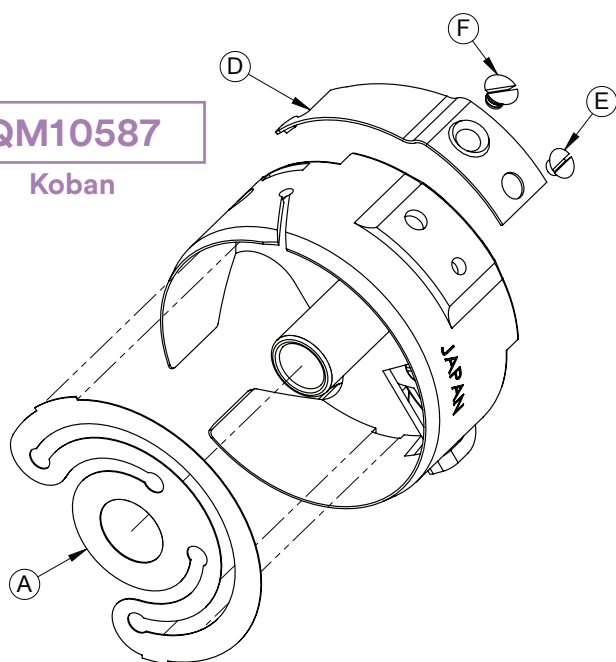

QM00586-01 • PRE-2017 CERLIANI BOBBIN CASE PARTS

ITEM	PART #	DESCRIPTION
A	QM00586-081-01	Bobbin Brake Spring
B	QM10589-103	Brake Spring Screw
C	QM10589-104	Brake Adjusting Screw
D	QM10589-92-01	Tension Spring
E	QM10589-94	Tension Spring Fastening Screw
F	QM10589-95	Tension Spring Adjusting Screw

QM00586 • POST-2017 CERLIANI BOBBIN CASE PARTS

ITEM	PART #	DESCRIPTION
A	QM10600	Bobbin Brake Spring
B	N/A	Brake Spring Screw
C	N/A	Brake Adjusting Screw
D	QM10589-92	Tension Spring
E	QM10589-94	Tension Spring Fastening Screw
F	QM10589-95	Tension Spring Adjusting Screw

HQ LONGARMS WITH CERLIANI BOBBIN CASES

HQ Sixteen	HQ Simply Sixteen
HQ Sweet Sixteen	HQ Fusion
HQ Avanté	HQ Amara
HQ Forte	HQ Capri

These machines generally have a silver hook.
The primary visual difference between these two bobbin cases is the bobbin brake spring (Item A).

QM10587 • KOBAN BOBBIN CASE PARTS

ITEM	PART #	DESCRIPTION
A	QM10587-081	Bobbin Brake Spring
B	N/A	Brake Spring Screw
C	N/A	Brake Adjusting Screw
D	QM10587-92	Tension Spring
E	QM10589-94	Tension Spring Fastening Screw
F	QM10589-95	Tension Spring Adjusting Screw

HQ LONGARMS WITH KOBAN BOBBIN CASES

HQ Simply Sixteen	HQ Forte
HQ Infinity	HQ Moxie

These machines generally have a black hook
which always use the Koban bobbin cases.